

ST REGIS
BAL HARBOUR

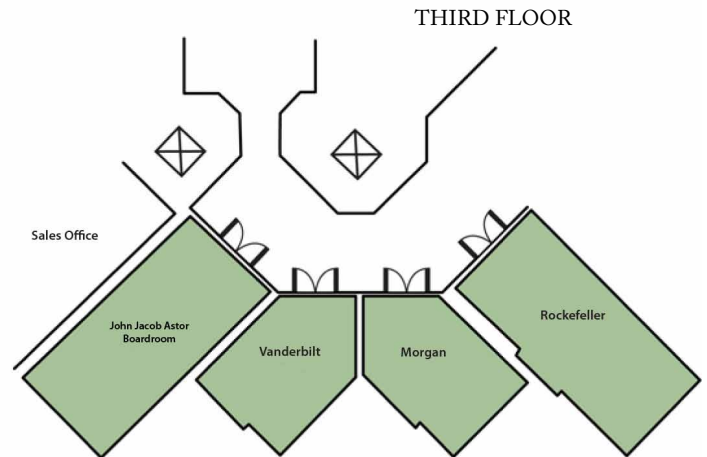

FLOOR	DIMENSIONS	TOTAL SQFT	CEILING HEIGHT	THEATRE	CONFERENCE	CLASS	U-SHAPE	BANQUET	RECEPTION
FIRST FLOOR									
ASTOR BALLROOM	82' x 95'	7,800	15.0'	844	-	432	-	630	800
ASTOR BALLROOM I	20' x 36'	720	15.0'	88	24	45	20	60	84
ASTOR BALLROOM II	20' x 36'	720	15.0'	83	22	42	18	56	79
ASTOR BALLROOM III	20' x 36'	720	15.0'	72	20	36	16	50	68
ASTOR BALLROOM IV	64' x 34'	2,176	15.0'	233	62	120	53	170	210
ASTOR BALLROOM V	64' x 25'	1,600	15.0'	211	45	108	38	150	200
ASTOR BALLROOM I & II	40' x 36'	1,440	15.0'	166	47	84	40	120	158
ASTOR BALLROOM I, II & III	60' x 36'	2,160	15.0'	244	67	126	58	180	232
ASTOR BALLROOM I, II, III & IV	60' x 70'	4,200	15.0'	477	129	246	110	350	453
ASTOR BALLROOM IV & V	60' x 59'	3,540	15.0'	444	106	230	91	330	421
ASTOR BALLROOM PRE-FUNCTION	82' x 24'	1,900	15.0'	255	-	-	-	190	242
ASTOR BALLROOM SECONDARY PRE-FUNCTION	95' x 20'	1,900	15.0'	277	-	-	-	130	168
ASTOR BALLROOM PRIMARY & SECONDARY PRE-FUNCTION	-	3,800	15.0'	-	-	-	-	328	421
THIRD FLOOR									
JOHN JACOB ASTOR BOARDROOM	29' x 12'	348	8.0'	38	12	18	10	24	39
VANDERBILT	21' x 12'	252	8.0'	27	8	12	7	20	26
MORGAN	21' x 12'	252	8.0'	27	8	12	7	20	26
ROCKEFELLER	29' x 12'	348	8.0'	38	12	18	10	24	39